

Comfort functions

Room heater (On X2 only)

- 室暖** To warm up the restroom.
- 冷感防止** To start warming up the restroom when the room temperature drops below 5°C.

- タイマー** To start warming up the restroom at the preset hour everyday. (You can choose from room heat hours 3, 6 or 9.)

Example

For room heat for 3 hours (5:00 - 8:00am).

- 1 Set the room heating time.** Press the button at a startup time (5 am).
 - 2 Set the start time.** Select "3" for the room heat hours.
- finish** The timer starts heating room at the preset time.



Auto functions

- ブラ洗浄** Sit down on the seat, and a small amount of water starts flowing to keep the inside of the bowl wet and clean.
- 流す** When you leave the seat, the toilet is flushed automatically.
- ふた開閉** The sensor senses a person for the lid to open and close itself.

POWER SAVE

- おまかせ** Hours which the toilet is least used are memorized. The seat temperature is automatically kept low during these hours to save power.

- 1 Press this switch.** Memory power save starting.

- おまかせ** Press this switch.

- タイマー** Once preset, the seat heater turn off at the preset hour everyday to save power. (You can choose from power save hours 3, 6 or 9.)

- 1 Set the power save time.** Press POWER SAVE [ON/OFF] at a desired power-save start hour (1:00am).
 - 2 Set the start time.** Select the power-saving time "6".
- finish** The timer starts saving power at the preset time.

TOTO

HOW TO USE

WASHLET NEOREST X1/X2

This sheet can be hung on the wall by hooks supplied with the product.

Flushing

- Stool** 大
- Urine** 小

The toilet can be flushed with the remote controller.

When the remote controller battery has run down

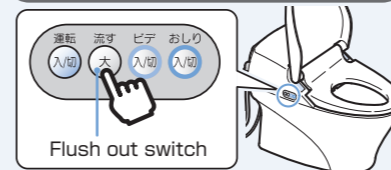

In case of power failure

Open the cover at the right and turn the Bowl clean-up lever to flush the toilet.

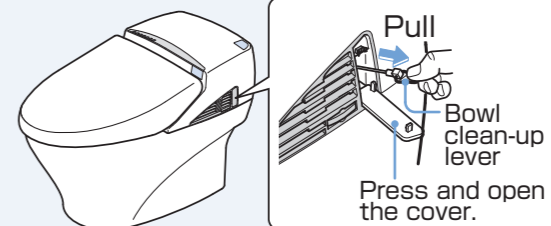

Open and close the seat and lid

- To close both the seat and lid.
- To open the lid and close the seat.
- To open both the seat and lid.

Extra deodorizing

- パワ-脱臭 Suction force is increased for extra deodorizing.

Drying

- 乾燥 To blow warm air and dry refreshed.

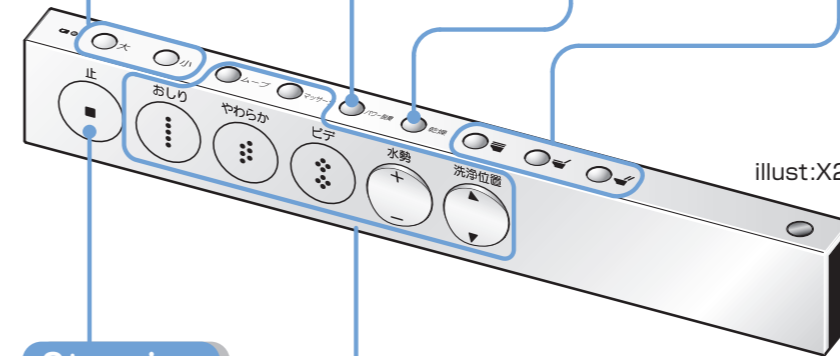

Washing

- おしり To wash the bottom.
- やわらか To wash the bottom with mild spray.
- ビデ For ladies.

Adjustment of water squirting force and washing position

- Water pressure and wash position are adjusted.



※Standard wash force and position are resumed each time the bottom, gentle or bidet button is pressed.

Comfortable washing

- ムーブ The nozzle moves back and forth during washing.
- マッサージ Water pressure changes for washing the bottom.

Stopping

- 止 To stop washing and drying.

TEMP ADJUST (illustr:X2)

Unhook the remote controller for use.

Press the temperature selector and use the temperature adjustor.

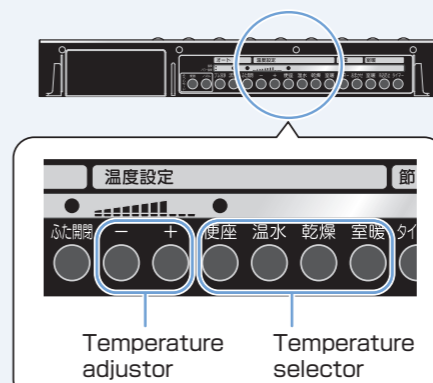

Main control panel

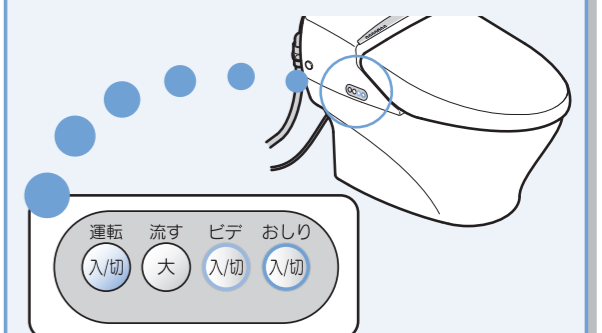

※Use these buttons if the batteries of the remote control are dead.