

# Standard Use

Press a button on the remote control; a beep sounds when the top unit receives the signal.

## Washing

For washing rear using mild water pressure.

Cleanses your rear.

Cleanses your front (for ladies).

Wide bidet washes your rear thoroughly and quickly using mild water pressure.

## Drying

Dries wet parts using warm air.

## Stopping

Stops the operation.

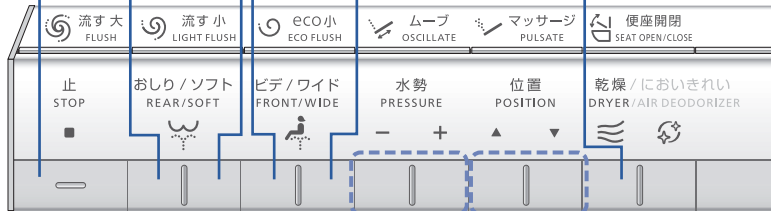

● The function that can be used when you press the “REAR”, “SOFT”, “BIDET” or “WIDE” button during use.

### ■PRESSURE

You can adjust the water pressure to one of five levels. (“-”: Softer, “+”: Stronger)

※When you press the button to flush, the position returns to the standard position(3rd position).

### ■POSITION

You can adjust the washing position to 5 different points between the front and the rear, using the “▲” and “▼” buttons.

### ■OSCILLATE

The wand moves back and forth to wash your rear thoroughly.

### ■PULSATE

Washes with the water pressure pulsating between soft and strong.

※The feature toggles between “ON/OFF” each time the switch is pressed.

Low battery warning mark



## Flushing

Full flush

Half flush

A small volume of water is used to flush the toilet bowl clean.

• Use this if the toilet paper is not flushed away.

## Opening and closing

Opens and closes the toilet seat.



### AIR DEODORIZER

• It eliminates disagreeable odors when you enter the bathroom.

■ You can flush the toilet bowl using the manual lever (for toilet bowl flushing in power failure) during power failure.

■ The toilet bowl can also be flushed clean by the FLUSHING button.

<With NX>

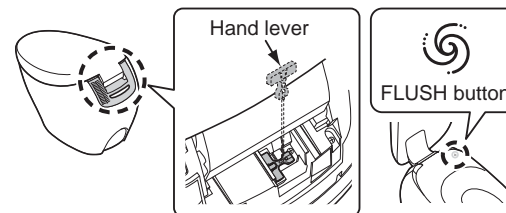

<With AH/RH>



More comfortable! More Energy-Savings!

# How to Use

List of menus that can be set by remote control.

The setting menus and their number differ according to the model.

Remoto control back side

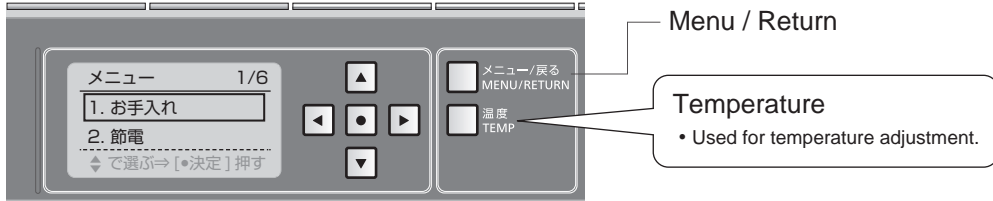



## How to set

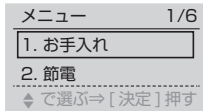

1 Press  MENU/RETURN



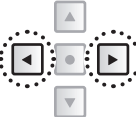

• The display screen changes.

2 Set the item from the display screen.

 When you move the  buttons (Up/Down), the frame of the item moves.

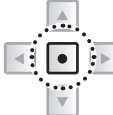
 When you move the  buttons (Right/Left), you can select "Enter".

 When you press the  button, the item is entered.

※The display goes out when no button on the remote control is pressed for about 60 sec or more.

You can set as desired

If you want to return to the previous item, press the  MENU/RETURN button.

Number of menus on the display screen

